

# Kalwall® Translucent Wall/Panel-Unit Wall System Details

## For 2 3/4" (70 mm) vertically oriented panels.

These are standard Clamp-tite™ details. Systems for other conditions, e.g. horizontally oriented, concealed fastener, Kalcurve™, Explosion Venting or Blast Resisting are similar, but do contact Kalwall for specifics. High-performance coatings in Kalwall Corrosion Resistant Finish are standard. CAD versions of these details and more available at [www.kalwall.com](http://www.kalwall.com).

**KALWALL SPAN TABLE — 4' (1200 mm) MODULE**  
Maximum Allowable Clearspan

|                           | Translucent Panel | Panel Unit Wall   | Nominal Grid Size           |
|---------------------------|-------------------|-------------------|-----------------------------|
| 2" (51 mm) Batten         | 12'-8" (3860 mm)  | 12'-5" (3785 mm)  | 12" x 24" (300 mm x 600 mm) |
| 2 3/4" (70 mm) ST+ #4SSSE | 16'-7" (5055 mm)  | 16'-5" (5005 mm)  | 12" x 24" (300 mm x 600 mm) |
| 3 1/4" (83 mm) IS-H       | 20'-11" (6375 mm) | 20'-9" (6325 mm)  | 12" x 24" (300 mm x 600 mm) |
| Silhouette Stiffener      | 25'-0" (7620 mm)  | 24'-11" (7595 mm) | 12" x 24" (300 mm x 600 mm) |

Clearspan at 25 p.s.f. (1.2 kPa) wind pressure, L/60 minimum. Spans based on engineering data and tests. Others possible. CAUTION! spans will vary with panel internal grid core size and orientation. Above based on grid oriented the panel length.

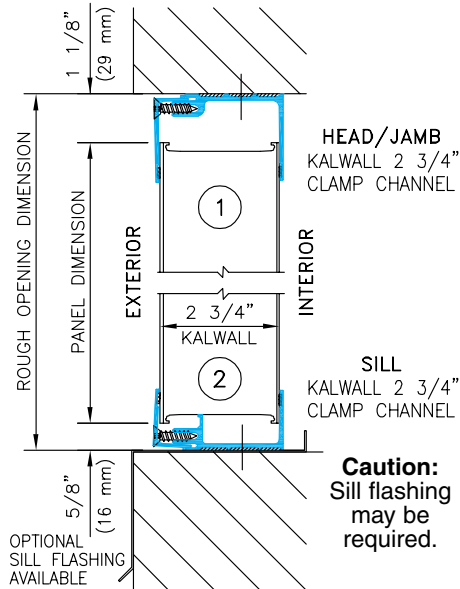

**Caution:**  
Sill flashing  
may be  
required.

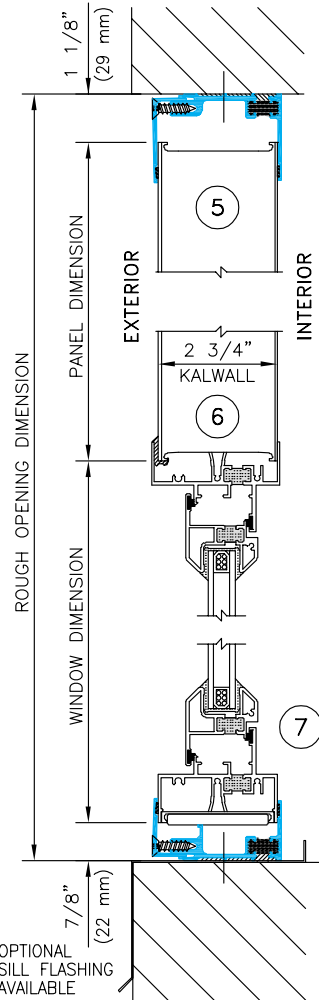
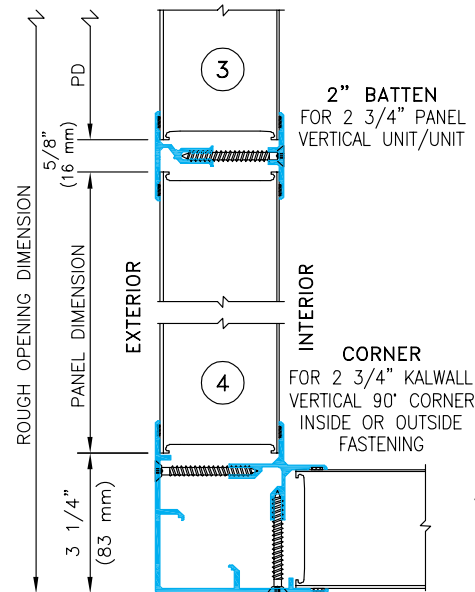

CONTINUOUS  
PERIMETER  
BED CAULK  
BY INSTALLER

KALWALL SEALING  
TAPES TYPICAL  
ALL JOINTS

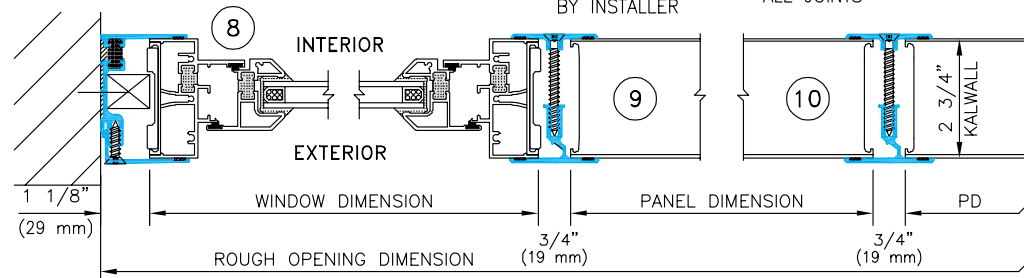

**Blue items are field  
installed and may  
require trimming.**

Details 5, 7, and 8 show  
thermally broken options.  
All Kalwall windows are  
thermally broken.

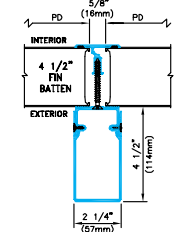
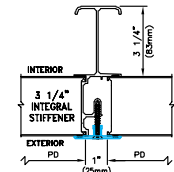
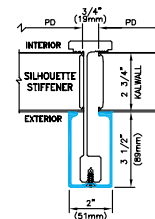
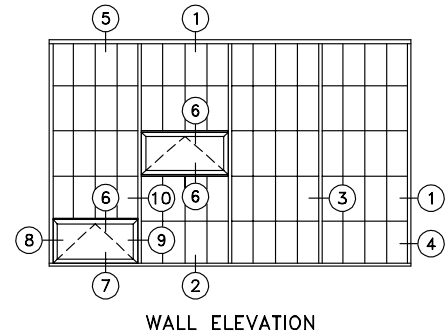

# Kalwall® Translucent Shed/Supported Ridge Skyroof™ Details

For 2¾" (70 mm) vertically and horizontally oriented flat panels.

Details for other conditions, e.g. Kalcurve™, self-supporting ridge, pyramid, hurricane or blast resistant are similar, but not identical so be sure to contact Kalwall.

Blue items are field installed and may require trimming.

Factory sealed perimeter frames.

SUPPORT AS REQUIRED BY OTHERS

SKYROOF PLAN A  
PANELS ON SLOPE – 2" BATTEN

SKYROOF PLAN B  
PANELS ACROSS SLOPE – OVERLAP SYSTEM

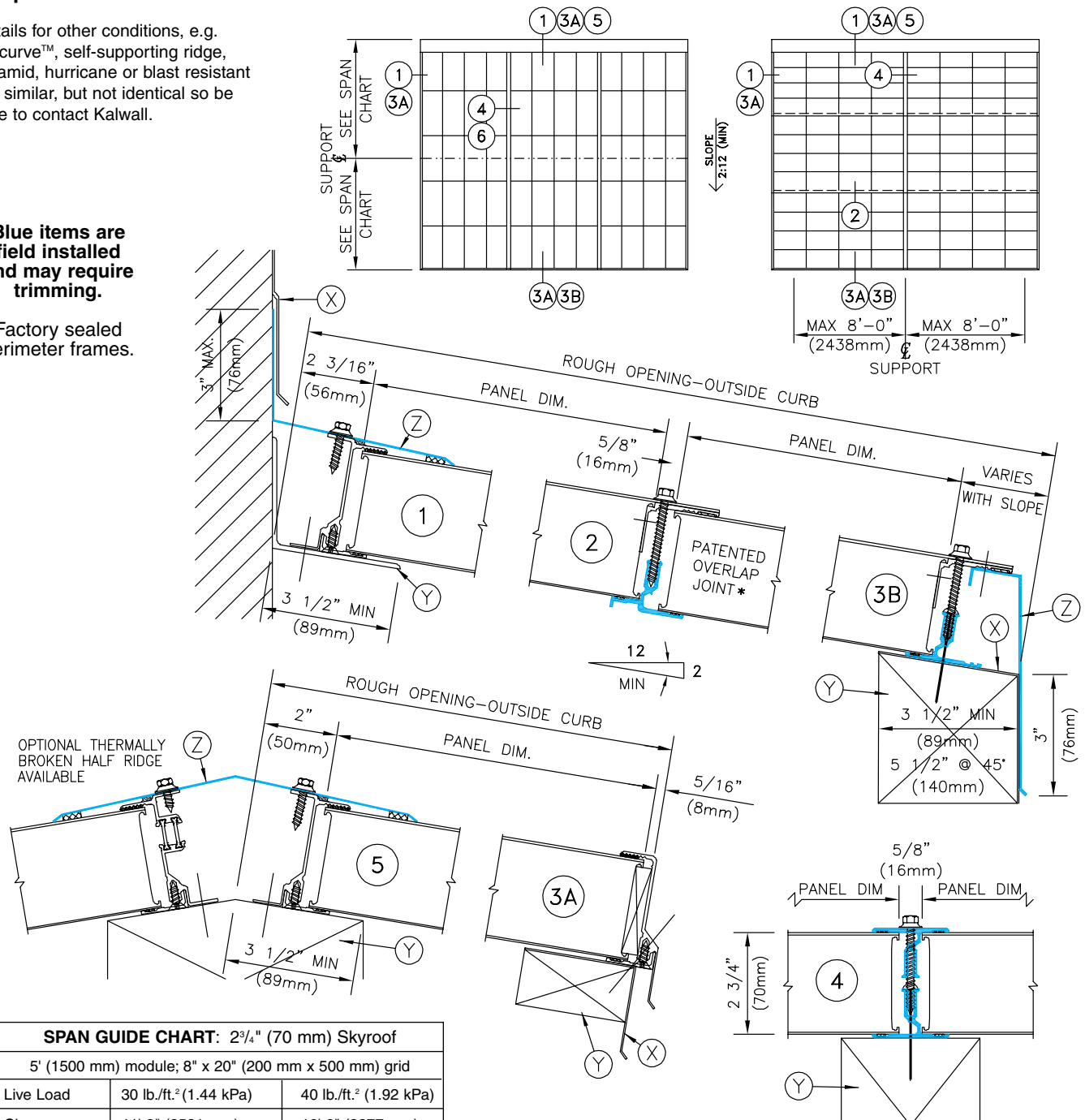

SPAN GUIDE CHART: 2¾" (70 mm) Skyroof

|   |                                    |                                    |
|---|------------------------------------|------------------------------------|
| 5' (1500 mm) module; 8" x 20" (200 mm x 500 mm) grid  |                                    |                                    |
| Live Load   | 30 lb./ft. <sup>2</sup> (1.44 kPa) | 40 lb./ft. <sup>2</sup> (1.92 kPa) |
| Clearspan   | 11'-9" (3581 mm)                   | 10'-9" (3277 mm)                   |
| 5' (1500 mm) module; 12" x 24" (300 mm x 600 mm) grid |                                    |                                    |
| Clearspan   | 10'-3" (3124 mm)                   | 9'-1" (2769 mm)                    |

Clearspan @ 25 p.s.f. (1.2 kPa) wind pressure, L/60 minimum.

**Note:** Longer clearspans possible. Contact factory.

**RECOMMENDED MINIMUM PITCH Skyroofs** (field installed panels) 2":12" (1:6)

**Note:** Exposed metal systems available in mill finish or Kalwall Corrosion Resistant Finish per AAMA 2604. Special finishes available as options.

- (X) COUNTER FLASHING NOT BY KALWALL
- (Y) SUPPORT NOT BY KALWALL
- (Z) STANDARD FLASHING BY KALWALL

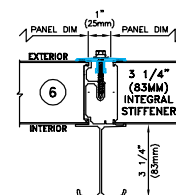

**NOTE:**  
PLEASE CHECK WITH  
FACTORY FOR  
ALLOWABLE SPANS  
IN YOUR LOCALE  
USING THIS 3/4" I.S.